

# IMPORTANT SAFETY INSTRUCTIONS

When using electrical appliances, especially when children are present, basic safety precautions should always be followed, including the following:

## FOR HOUSEHOLD USE ONLY

**READ ALL INSTRUCTIONS BEFORE USING—SAVE THESE INSTRUCTIONS**

### **WARNINGS: KEEP AWAY FROM WATER**

#### **DANGER—**

As with most electrical appliances, electrical parts are electrically live even when the switch is off.

#### **⚠ WARNING**

To reduce the risk of death by electric shock:

1. Always unplug the unit immediately after using.
2. Do not use while bathing.
3. Do not place or store appliance where it can fall or be pulled into a tub or sink.
4. Do not place in or drop into water or other liquid.
5. If an appliance falls into water, unplug the unit immediately. Do not reach into the water.

#### **⚠ WARNING**

To reduce the risk of burns, electrocution, fire, or injury to persons:

1. An appliance should never be left unattended when plugged in.
2. Close supervision is necessary when this appliance is used by, on, or near children or individuals with certain disabilities.
3. Use this appliance only for its intended use as described in this manual. Do not use attachments not recommended by the manufacturer.
4. Never operate this appliance if it has a damaged cord or plug, if it is not working properly, or if it has been dropped, damaged, or dropped into water.
5. Keep the cord away from heated surfaces.
6. Do not wrap the cord around the appliance.
7. Never block the air openings of the appliance or place it on a soft surface, such as a bed or couch, where the air openings may be blocked. Keep the air openings free of lint, hair, and the like.
8. Never use while sleeping.

9. Never drop or insert any object into any opening.
10. Do not use outdoors or operate where aerosol (spray) products are being used or where oxygen is being administered.
11. Do not use an extension cord with this appliance.
12. Do not direct hot air toward eyes or other heat-sensitive areas.
13. Attachments may be hot during use. Allow them to cool before handling.
14. Do not place appliance on any surface while it is operating.
15. While using the appliance, keep your hair away from the air inlets.
16. Do not operate with a voltage converter.
17. Only use the appliance with the voltage, frequency and power shown on the rating label on the product.
18. Do not use this appliance on hair extensions or wigs unless recommended by the hair extension or wig manufacturer.
19. If hair styling product is being used in conjunction with this appliance please read and follow all of the hair styling product safety warnings and instructions before use.
20. In a double-insulated appliance, two systems of insulation are provided instead of grounding. No grounding means is provided on a double-insulated appliance, nor should a means of grounding be added to the appliance. Servicing a double-insulated appliance requires extreme care and knowledge of the system, and should be done only by qualified service personnel. Replacement parts for a double-insulated appliance must be identical to the parts they replace. A double-insulated appliance is marked with words "DOUBLE INSULATION" or "DOUBLE INSULATED." The symbol (square within a square) may also be marked on the appliance.

## SAVE THESE INSTRUCTIONS

For accessories and replacement parts, visit [sharkclean.co.uk/accessories](http://sharkclean.co.uk/accessories)

**SCAN QR CODE FOR FULL INSTRUCTIONS, WARRANTY INFORMATION, AND HOW-TOS**



**Do not use this appliance near bathtubs, showers, basins or other vessels containing water.**



**TECHNICAL SPECIFICATIONS** Voltage: 220-240V 50-60Hz | Power 1500W

© 2025 Shark Ninja Operating LLC: SHARK is a registered trademark in the United Kingdom of SharkNinja Operating LLC.

HD6000UK\_Series\_Warning\_Insert\_MP\_W7\_Mv2

## OPERATING INSTRUCTIONS

1. Turn the styler on and off by toggling the 3-position switch. Wet Hair drying and styling is at the top of the toggle and Dry Hair styling/refresh is in the middle of the toggle.
2. Adjust the airflow. Pressing the button allows you to choose a low, medium, or high airflow.
3. Adjust the temperature. Pressing the button allows you to choose no heat, low, medium, or high temperature. For Scalp Shield, press and hold Temperature button for 2 seconds.

| ACCESSORY PLATE TEMPERATURES |                     |                    |                    |
|------------------------------|---------------------|--------------------|--------------------|
| <b>WET MODE</b>              | High -120°C (248°F) | Med -110°C (230°F) | Low -100°C (212°F) |
| <b>DRY MODE</b>              | High -220°C (428°F) | Med -200°C (392°F) | Low -180°C (356°F) |

4. Press and hold the Cool Shot button for a cool burst of air to set your style.
5. To attach any accessory included with your styler, line up the open arrow on the back of the accessory with the arrow on the back of the styler. Press and twist the accessory into the styler's nozzle toward the left so the solid arrow on the accessory lines up with the arrow on the back of the styler. The accessory is properly attached when it clicks into place.
6. To remove an accessory from the styler, slide the top lock down, then lift and simultaneously twist the accessory to the right and lift it off the styler's nozzle by holding onto the cool touch points. To detach the Straightener, it is recommended to hold the styler in your left hand while using your right hand to unlock and remove the Straightener at the same time. Your thumb will pull down the lock while your hand twists and pulls up to release.
7. To change from styling wand mode to hair dryer mode, slide down the lock and rotate the nozzle left. Keep rotating the nozzle until it clicks into place in hair dryer mode. To change from hair dryer mode to styling wand mode, slide down the lock and rotate the nozzle right.
8. To remove the filter cover, slide it off the bottom of the unit. To attach the filter cover, slide it back on to the bottom of the unit until it clicks in place.
9. Press the RCD button to rest the dryer. See Troubleshooting & Error Codes for more information.
10. Rating label location.

For further operating instructions, scan the QR code on the cover of this booklet.

### Storage, Cord Safety, and Maintenance/Cleaning:

- Ensure the cord is not knotted, twisted, or wrapped around any nearby objects when in use.
- Store the unit in a dry location away from water and other heat sources. Store brush accessories so the bristles are not touching any surfaces to help prevent bristle damage.
- Clean the filter at the bottom of the unit monthly. To clean the filter, first slide the filter cover off the bottom of the unit. Then use a new toothbrush to brush off any dust or debris on the filter. Once the filter is clean, slide the filter cover back on the unit until it clicks in place.
- Remove any hair on the brush accessories after every use to help maintain performance.

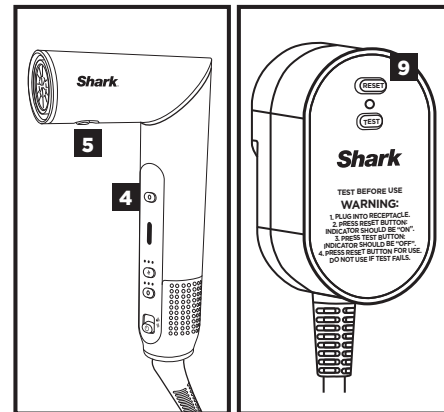
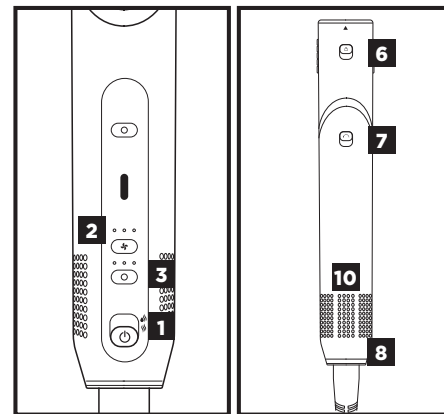

## TWO (2) YEAR LIMITED WARRANTY

When a consumer buys a product in the UK, they get the benefit of legal rights relating to the quality of the product (your "statutory rights"). You can enforce these rights against your retailer. However, at Shark we are so confident about the quality of our products that we give you an additional manufacturer's guarantee of up to two years (one year, plus an additional year upon registration). Offer valid only in the United Kingdom. These terms and conditions relate to our manufacturer's guarantee only – your statutory rights are unaffected.

The conditions below describe the prerequisites and scope of our guarantee. They do not affect your statutory rights or the obligations of your retailer and your contract with them.

### Shark® Guarantees

Your Shark unit constitutes a sizeable investment. Your new hairdryer needs to work properly for as long as possible. The guarantee it comes with is an important consideration - and reflects how much confidence the manufacturer has in its product and manufacturing quality.

Every Shark machine comes with a free parts and labour guarantee. Our customer service helpline (**0800 862 0453**) is open from 9.00am to 6.00pm Monday - Friday. It's free to call and you'll be put straight through to a Shark representative. You'll also find online support at [sharkclean.co.uk](https://www.sharkclean.co.uk)

### How do I register my Shark® guarantee?

Purchases made from the Shark website are automatically registered for the two year extended guarantee. You can register your guarantee online within 28 days of purchase. To save time, you'll need the following information about your hairdryer:

- Date you purchased the unit (receipt or delivery note).

To register online, please visit [sharkclean.co.uk](https://www.sharkclean.co.uk)

### IMPORTANT

- The guarantee will only cover your product from the date of purchase.
- Please keep your receipt at all times. Should you need to use your guarantee we will need your receipt to verify the information you have supplied to us is correct. The inability to produce a valid receipt may invalidate your guarantee.

### What are the benefits of registering my free Shark® guarantee?

When you register your guarantee we'll have your details to hand if we ever need to get in touch.

You can also receive tips and advice on how to get the best out of your Shark unit and hear the latest news about new Shark® technology and launches. If you register your guarantee online, you'll get instant confirmation that we've received your details.

### How long are new Shark® machines guaranteed for?

Our confidence in our design and quality control means that your new Shark unit is guaranteed for up to two years (initial one-year guarantee and the additional one-year extension upon registration).

### What is covered by the free Shark® guarantee?

Repair or replacement of your Shark machine (at Shark's discretion), including all parts and labour. A Shark guarantee is in addition to your statutory rights as a consumer.

### What is not covered by the free Shark® guarantee?

1. Normal wear and tear of wearable parts (such as accessories). Replacement parts are available for purchase at [sharkclean.co.uk](https://www.sharkclean.co.uk)
2. Damage caused by misuse, abuse, negligent handling, failure to perform required maintenance or damage due to mishandling in transit.
3. Damage caused by maintenance not authorised by Shark.

### Where can I buy genuine Shark® spares and accessories?

Shark spares and accessories are developed by the same engineers who developed your Shark unit. You'll find a full range of Shark spares and replacement parts/accessories for all Shark machines at [Sharkclean.co.uk](https://www.sharkclean.co.uk)

Please remember that damage caused by the use of non-Shark spares may not be covered under your guarantee.

## TROUBLESHOOTING & ERROR CODES

### MAINTENANCE/CLEANING

#### Reduction in Airflow.

Make sure you are not covering the filter cover with your hand when operating the unit. This will block the air inlet, which could cause a reduction in airflow. A change in airflow or air power, airflow blockages, and/or visible buildup on the inlet at the bottom of the unit could also indicate your unit needs to be cleaned. To maintain performance, clean the filter at the bottom of the unit every month, using a new toothbrush.

#### Removing the Filter

1. Turn off the device and unplug it. Slide the filter cover off the bottom of the unit.

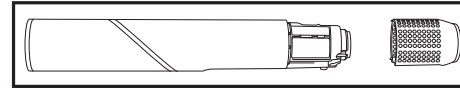

#### Cleaning the Filter

1. Wipe down the filter with a dry microfibre cloth or a new toothbrush to remove the debris.
2. To reinstall the filter cover, slide it back on to the bottom of the device until it clicks into place.

#### Maintaining Accessory Connection Pins.

Keep pins clean for best performance. Turn off the device and unplug it. If you notice any debris on accessory pins, wipe clean with a dry cloth. Do not rest accessories on wet surfaces. Ensure pins are clean before every use.

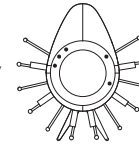

### RCD OPERATION

#### Electricity flickers or trips circuit breaker during use.

This dryer is equipped with a Residual Current Device (RCD), a safety feature that renders it inoperable under abnormal conditions. The RCD Reset button must be pressed any time the device is plugged in for use, otherwise it will not turn on. Should the device turn off in use, ensure there are no other appliances plugged in within the room where the dryer is being used. Do not use the dryer with an extension lead.

### OVERHEATING

#### Hair dryer is overheating or shuts off.

This unit is equipped with a temperature-protective thermostat. If for some reason your hair dryer overheats, the thermostat will automatically turn the unit off. To prevent power-down recurrence, unplug the hair dryer and set it aside to cool, or cool down using the Cool Shot button during use. Overheating may result if the unit is powered on for a long duration, or can indicate a blockage or dust buildup. To prevent overheating, clean the filter at the bottom of the unit every month, using a new toothbrush. Make sure you are not covering the filter with your hand when operating the unit, as this could also cause overheating. If overheating continues to occur, contact Customer Service at **0800 862 0453**.

### Overheating Error Code



If you are experiencing a different error code, please **scan the QR code** for additional troubleshooting or contact Customer Service at **0800 862 0453**.

## HOW-TO VIDEOS

---

# ***Shark* Glam**

SCAN FOR PERSONALISED VIDEOS

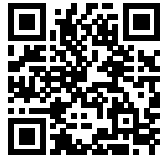

SharkNinja Europe Limited,  
1st/2nd Floor Building 3150,  
Thorpe Park, Century Way, Leeds,  
England, LS15 8ZB  
Telephone: +44 (0)800 862 0453  
[www.sharkclean.co.uk](http://www.sharkclean.co.uk)

SharkNinja Germany GmbH,  
Rotfeder-Ring 9,  
3rd Floor,  
60327 Frankfurt am Main,  
Germany

