

Please make sure to read the enclosed Ninja® Owner's Guide prior to using your unit.

NINJA

PRECISION PROCESSOR™ QUICK ASSEMBLY

PRECISION PROCESSOR™

PARTS

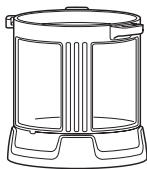

**PRECISION
PROCESSOR BOWL**



BOWL LID



**CHOPPING BLADE
ASSEMBLY**

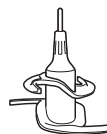

**DOUGH BLADE
ASSEMBLY**

ASSEMBLY

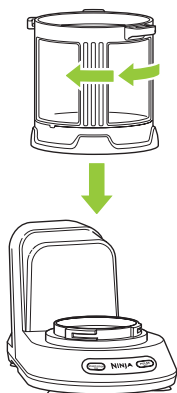

- 1.**
Place Precision Processor Bowl on base and turn clockwise to lock in place.

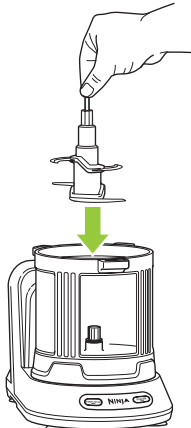

- 2.**
Holding the blade assembly by the top of the shaft, insert it into bowl.

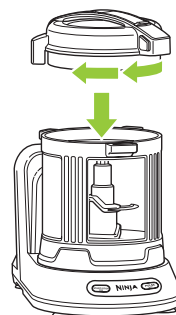

- 3.**
Lower Bowl Lid onto bowl and turn clockwise to lock in place.

Programs will illuminate once container is correctly assembled onto the base and the unit is connected to power.



WARNING: Chopping Blade Assembly is sharp and not locked in place. Before emptying contents, carefully remove blade assembly. Failure to do so will result in a risk of laceration. Refer to the Ninja Owner's Guide for additional information.

QUESTIONS? We're here to help. Call 1-877-646-5288 or visit ninjakitchen.com

Please make sure to read the enclosed Ninja® Owner's Guide prior to using your unit.

PROCESSING



1. Select the desired program to begin.

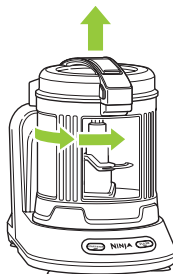

2. Remove bowl from base by turning it counterclockwise, then lifting it up.

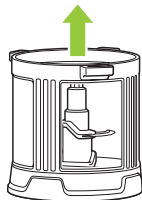
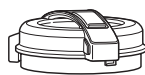

3. Remove lid by pressing the release button on side of front tab, then twisting counterclockwise and lifting up.

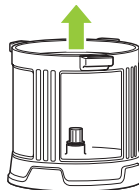
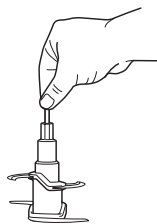

4. Remove blade assembly before emptying bowl.

Programs will illuminate once container is correctly assembled onto the base and the unit is connected to power.



WARNING: Chopping Blade Assembly is sharp and not locked in place. Before emptying contents, carefully remove blade assembly. Failure to do so will result in a risk of laceration. Refer to the Ninja Owner's Guide for additional information.

CLEANING

Dishwasher: The container, lid, and blade assemblies are all dishwasher safe. The lid and blade assemblies are top-rack dishwasher safe. Ensure the blade assembly is removed from the container before placing in the dishwasher.

Hand washing: Wash container, lid, and blade assemblies in warm, soapy water. When washing the blade assemblies, use a dishwashing utensil with a handle to avoid direct hand contact with blades. Handle blade assemblies with care to avoid contact with sharp edges. Rinse and air-dry thoroughly.



WARNING: Handle the Chopping Blade Assembly with care when washing, as the blades are sharp. Contact with the blades' edges can result in laceration.

QUESTIONS? We're here to help. Call 1-877-646-5288 or visit ninjakitchen.com