

Please make sure to read the enclosed Ninja® Owner's Guide prior to using your unit.

NINJA[®]CHEF™ HIGH-SPEED BLENDER QUICK ASSEMBLY

PITCHER

PARTS

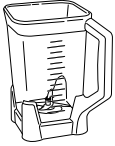

PITCHER



PITCHER LID



LID CAP

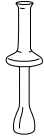

TAMPER

ASSEMBLY

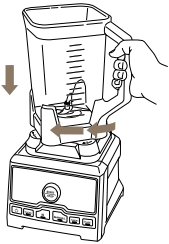

1. Lower pitcher onto motor base, then rotate clockwise until it clicks into place.

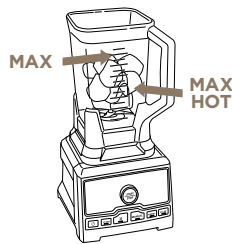

2. Add ingredients to pitcher, making sure not to exceed Max Fill line. **Hot ingredients cannot exceed the Max Hot Liquid line.**



3. Place lid onto pitcher, then press down firmly, making sure that both side clips on lid fully snap onto lip of pitcher.

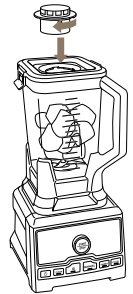

4. Insert lid cap into lid and turn clockwise to lock.



WARNING: Pitcher's bottom blades are sharp. Contact with the blades can result in laceration.

IN USE

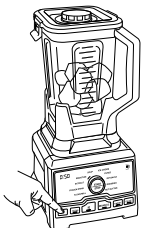

BLENDING

Press the power button. The base defaults to Auto-iQ® Mode. Select the desired program and press START/STOP, or press MANUAL to switch modes and use the dial to select blending speed.

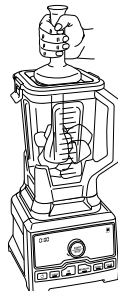

TAMPER

If unmixed ingredients are sticking to the pitcher, remove lid cap and use tamper to push ingredients closer to the blades.

SEE REVERSE SIDE TO LEARN MORE ABOUT AUTO-IQ AND MANUAL MODES.

QUESTIONS? We're here to help. Call 1-877-646-5288 or visit ninjakitchen.com

Please make sure to read the enclosed Ninja® Owner's Guide prior to using your unit.

AUTO-iQ® AND MANUAL MODES

AUTO-iQ MODE

10 unique timed programs customized to take the guesswork out of making great drinks and meals.

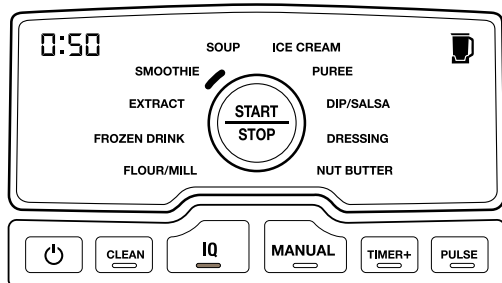

MANUAL MODE

Turn the dial from 1 to 10 for total control of blending speed. Press START/STOP to begin and end blending.

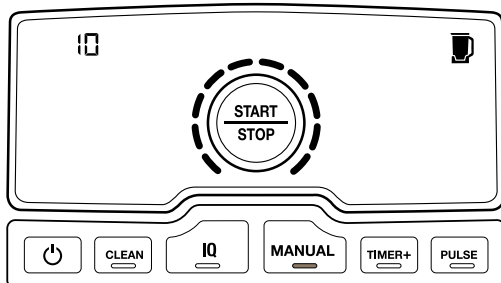

SELECT AND RUN AN AUTO-iQ PROGRAM

Turn dial to select the desired program, then press the START/STOP dial to begin. As the program runs, the timer will count down. When the countdown ends, blending will stop automatically.

OTHER MODES

CLEAN

To run the self-cleaning program, first add warm water up to the MAX CLEAN line and two drops of dishwashing soap to the pitcher. Secure pitcher lid and lid cap in place. Select CLEAN mode, then press START/STOP to begin. The unit will shut down when cleaning cycle is complete. Make sure to thoroughly rinse and air-dry the pitcher.

TIMER+

Use TIMER+ mode to set a countdown timer. Select TIMER+ and add blend time in 10-second intervals by repeatedly pressing the TIMER+ button. Set the speed by rotating the dial to the desired setting. Press START/STOP to activate the unit. Blending will stop automatically when countdown is complete.

PULSE

Select PULSE and turn dial to desired speed. Press START/STOP button in short bursts to pulse. The unit will blend only while button is pressed.

CLEANING

Dishwasher: All attachments are dishwasher safe. It is recommended that the tamper, lid, and cap be placed on the top rack of the dishwasher. Exercise care when handling pitcher, as bottom blades are sharp.

Hand-washing: Wash pitcher in warm, soapy water using a dishwashing utensil with a handle to avoid direct contact with the blades. Exercise care when washing pitcher, as bottom blades are sharp. Thoroughly rinse and air-dry all parts.



WARNING: Handle the pitcher with care when washing, as the bottom blades are sharp. Contact with the blades' edges can result in laceration.

QUESTIONS? We're here to help. Call **1-877-646-5288** or visit **ninjakitchen.com**