

Shark®

STEAM AND SCRUB MOP

QUICK START GUIDE

ASSEMBLY

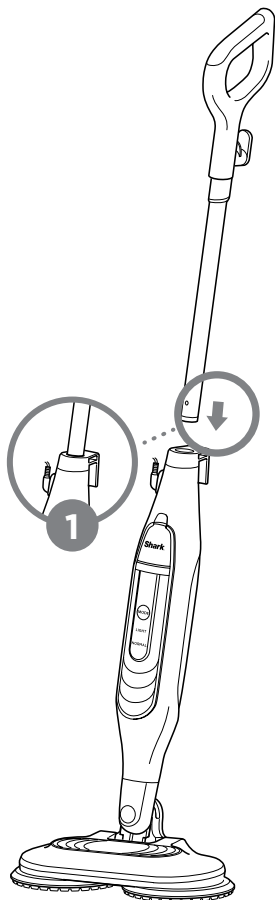

1. Insert the steam mop handle into the steam mop body until it clicks securely into place.

WHAT'S INSIDE

- A Steam Mop Handle
- B Steam Mop Body
- C Dirt Grip™ Pads
- D Filling Flask

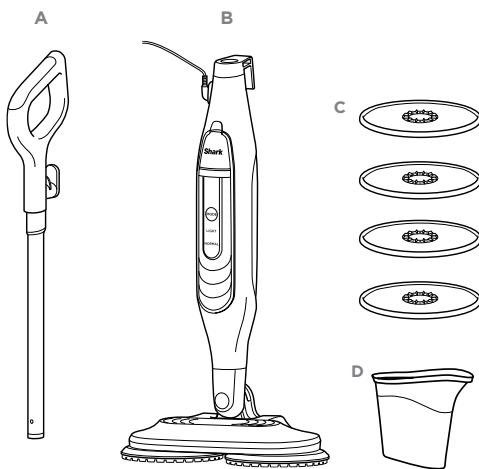

FILLING THE WATER TANK

1. To open the water tank, pull the lid down.
2. Use the filling flask to pour water into the tank. Make sure not to exceed the Max Fill Line on the flask. When finished, close the tank lid firmly.

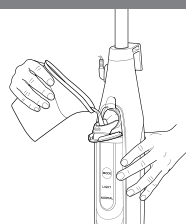

DIRT GRIP™ PADS

ATTACHING THE PADS

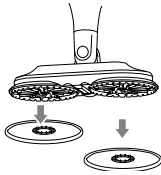

1. Place the Dirt Grip™ pads flat on the floor with the plastic rings facing up.
2. Hold the nozzle over the pads. Align the indent on the nozzle's rotating discs with the plastic rings on the pads.

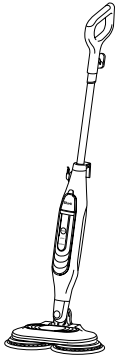

3. Gently lower the nozzle onto the pads, pressing until the pads are secured.

REMOVING THE PADS

When the pads have cooled completely, remove them by gently pulling them off the discs.

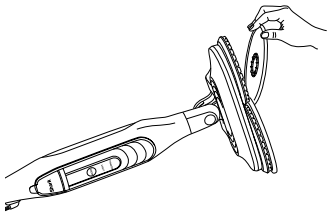

USING THE STEAM MOP

1. Twist the quick-release cord holder to unwrap the power cord completely, and plug the cord into an electrical socket. The steam mop power light will illuminate.
2. Press the mode button once for light or twice for normal.
3. To start cleaning, put your foot on the floor head and pull the handle towards you. This will engage the power pads. Mop with a forward and backward motion.
4. When finished mopping, press the mode button and the blue indicator lights will blink, indicating that the unit is in Standby Mode, and the rotating discs will stop spinning. When the mop is in Standby mode, lift the handle to bring the Steam Mop back to the upright position and unplug the cord.

