

NOTE: SAVE THESE INSTRUCTIONS. KEEP FOR FUTURE REFERENCE.

IMPORTANT SAFETY INSTRUCTIONS

HOUSEHOLD USE ONLY • READ ALL INSTRUCTIONS BEFORE USE

To reduce the risk of shock and unintended operation, turn off power and remove the ION Power Pack battery before servicing. NOTE: If you have delicate or wool carpets, particularly loop pile, please try the vacuum on a hidden area first to ensure the spinning brush-rolls do not damage or unpick carpet fibres.

⚠ WARNING

REDUCE THE RISK OF FIRE, ELECTRIC SHOCK, INJURY, OR PROPERTY DAMAGE.

- 1 This vacuum consists of a motorised nozzle, wand, and handheld vacuum. These components contain electrical connections, electrical wiring, and moving parts that potentially present risk to the user.
- 2 Before each use, carefully inspect all parts for any damage. If a part is damaged, discontinue use.
- 3 Use only identical replacement parts.
- 4 This vacuum contains no serviceable parts.
- 5 Use only as described in this manual. **DO NOT** use the vacuum for any purpose other than those described in this manual.
- 6 With the exception of the filters and dust cup, **DO NOT** expose any parts of the vacuum to water or other liquids.
- 7 **DO NOT** allow the appliance to be used by children. Keep the appliance and its cord out of reach of children. Do not allow to be used as a toy. Close supervision is necessary when used near children.

GENERAL USE

- 8 This appliance can be used by persons with reduced physical, sensory or mental capabilities or lack of experience and knowledge if they have been given supervision or instruction concerning use of the appliance in a safe way and understand the hazards involved. Cleaning and user maintenance should not be done by children.
- 9 Always turn off the vacuum before connecting or disconnecting any current carrying hoses, motorised nozzles, chargers, batteries, or other electrical or mechanical parts.
- 10 **DO NOT** handle plug or vacuum with wet hands.
- 11 **DO NOT** use without dust cup, filters, and brush-roll in place.
- 12 Only use Shark® branded filters and accessories. Damage caused by non-Shark filters and accessories may not be covered by the guarantee.
- 13 **DO NOT** put any objects into nozzle or accessory openings. **DO NOT** use with any opening blocked; keep free of dust, lint, hair, and anything that may reduce airflow.
- 14 **DO NOT** use if nozzle or accessory airflow is restricted. If the air paths or the motorised floor nozzle become blocked, turn the vacuum off. Remove all obstructions before you turn on the unit again.
- 15 Keep nozzle and all vacuum openings away from hair, face, fingers, uncovered feet, or loose clothing.
- 16 **DO NOT** use if vacuum is not working as it should, or has been dropped, damaged, left outdoors, or dropped into water.
- 17 Use extra care when cleaning on stairs.
- 18 **DO NOT** leave the vacuum unattended while powered on.
- 19 When powered on, keep the vacuum moving over the carpet surface at all times to avoid damaging the carpet fibres.
- 20 If you have delicate or wool carpets, particularly loop pile, please try the vacuum on a hidden area first to ensure the spinning brush-rolls do not damage or unpick carpet fibres.

- 21 **DO NOT** use to pick up:
 - a) Liquids
 - b) Large objects
 - c) Hard or sharp objects (glass, nails, screws, or coins)
 - d) Large quantities of dust (including drywall, fireplace ash, or embers). **DO NOT** use as an attachment to power tools for dust collection.
 - e) Smoking or burning objects (hot coals, cigarette butts, or matches)
 - f) Flammable or combustible materials (lighter fluid, petrol, or kerosene)
 - g) Toxic materials (chlorine bleach, ammonia, or drain cleaner)
- 22 **DO NOT** use in the following areas:
 - a) Poorly lit areas
 - b) Wet or damp surfaces
 - c) Outdoor areas
 - d) Spaces that are enclosed and may contain explosive or toxic fumes or vapours (lighter fluid, petrol, kerosene, paint, paint thinners, mothproofing substances, or flammable dust)
- 23 Turn off the vacuum before plugging in or unplugging the charger.
- 24 Turn off the vacuum before any adjustment, cleaning, maintenance or troubleshooting.
- 25 During cleaning or routine maintenance, **DO NOT** cut anything other than hair, fibres, or string wrapped around the brush-roll.
- 26 Allow all filters to air-dry completely before replacing in the vacuum to prevent liquid from being drawn into electric parts.
- 27 **DO NOT** modify or attempt to repair the vacuum or the battery yourself, except as indicated in this manual. **DO NOT** use the battery or vacuum if it has been modified or damaged. Damaged or modified batteries may exhibit unpredictable behavior resulting in fire, explosion or risk of injury.
- 28 Turn off all controls before unplugging.
- 29 Always turn off this appliance before connecting or disconnecting motorised nozzle or hand tool.

BATTERY PACK

- 30 The battery is the power source for the vacuum. Carefully read and follow all charging instructions.
- 31 To prevent unintentional starting, ensure the vacuum is powered off before picking up or carrying the vacuum. **DO NOT** carry the appliance with your finger on the power switch.
- 32 Use only the charger supplied with the unit. Use of an incorrect charger may result in no charging, and/or unsafe conditions. A charger that is suitable for one type of battery pack may create a risk of fire when used with another battery pack.
- 33 Keep the battery away from all metal objects such as paper clips, coins, keys, nails, or screws. Shorting the battery terminals increases the risk of fire or burns.

- 34 Under abusive conditions, liquid may be ejected from the battery. Avoid contact with this liquid, as it may cause irritation or burns. If contact occurs, flush with water. If liquid contacts eyes, seek medical help.
- 35 Battery should not be stored at temperatures below 3°C (37.4°F) or above 40°C (104°F) to maintain long-term battery life.
- 36 **DO NOT** charge battery at temperatures below 5°C (40°F) or above 40°C (104°F). Charging improperly or at temperatures outside of the specified range may damage the battery and increase the risk of fire.
- 37 Store the appliance indoors. **DO NOT** use or store it below 3°C (37.4°F). Ensure the appliance is at room temperature before operating.
- 38 **DO NOT** expose the battery to fire or temperatures above 130°C (265°F) as it may cause explosion.
- 39 Use appliances only with specifically designated battery packs. Use of any other battery packs may create a risk of injury and fire.
- 40 Disconnect the battery pack from the appliance before making any adjustments, changing accessories, or storing appliance. Such preventive safety measures reduce the risk of starting the appliance accidentally.

ODOUR

- 41 Observe the following when interacting with the Anti-Odour Cartridge cartridge:
 - a) **DO NOT** attempt to disassemble odour neutralising cartridge.
 - b) Avoid direct contact with the fragrance pod in the cartridge.
 - c) **DO NOT** directly inhale from the odour neutralising cartridge.
 - d) Keep away from children and pets.
 - e) Keep away from heat, sparks, and open flame.
 - f) **DO NOT** place in direct sunlight.

FRAGRANCE CARTRIDGE FIRST AID

- 42 Observe the following when interacting with the Anti-Odour Technology cartridge:
 - a) Avoid contact with fabrics and finished surfaces.
 - b) Eye contact: Remove contact lenses if present. Rinse continuously with water for several minutes.
 - c) Skin contact: Wash hands thoroughly after handling. If irritation or rash develops, seek medical advice/attention.
 - d) Inhalation: Move person to fresh air if they are experiencing any respiratory symptoms. If symptoms persist, seek medical advice/attention.
 - d) Ingestion: **DO NOT** induce vomiting. Seek medical advice/attention.

READ AND SAVE THESE INSTRUCTIONS

visit qr.sharkclean.com/IZ400 or
SCAN HERE USING YOUR SMARTPHONE CAMERA



FOR FULL INSTRUCTIONS, GUARANTEES
AND REPLACEMENT PARTS.



ANTI-ODOUR TECHNOLOGY WARNING

May cause an allergic reaction to skin if in direct contact with contents of cartridge. Wear protective gloves if directly coming into the contact with the cartridge material, wash skin thoroughly after handling. Harmful if swallowed. Avoid breathing in mist or vapours, intentional misuse and directly inhaling contents may be dangerous. Avoid release to the environment. Very toxic to aquatic life with long lasting effects, ensure cartridge is disposed of correctly as general waste.

Please be sure to read and save the warnings on other side prior to using your unit.

QUICK START GUIDE

How to set up the Shark IZ400 Cordless Vacuum with Anti-Odour Technology, Clean Sense IQ and Anti-Hair Wrap Plus.

SETTING UP YOUR UNIT

1. Insert **Wand** into **Floor Nozzle**.
2. Insert **Handheld Vacuum** into **Wand**.
3. Remove **Anti-Odour Technology Dial** from the tin. Flip up the dial handle, align the teal arrows, then insert the dial into the nozzle.
4. Once read, remove the peelable stickers from the floor nozzle and the hand vacuum digital display.

Before use, ensure all components are completely connected and clicked into place. Please note, stickers on the floor head for the clean indicator and on the hand vacuum display screen are peelable and should be removed.

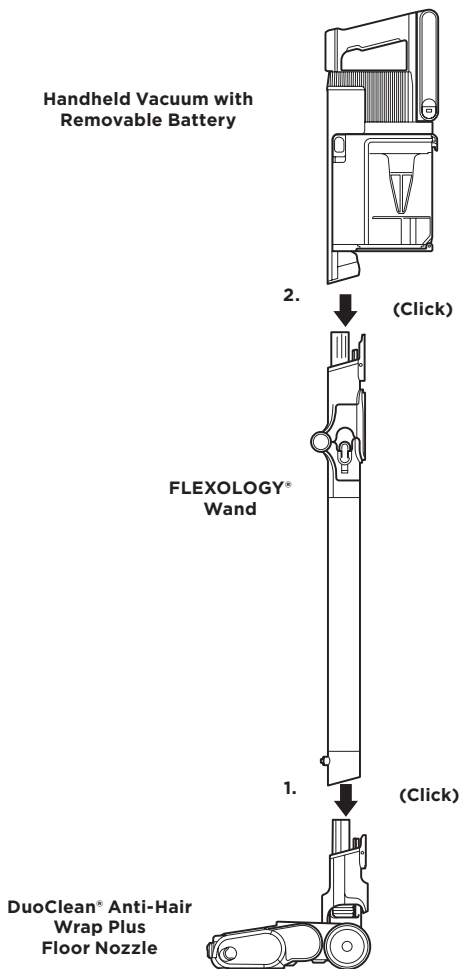

SETTINGS

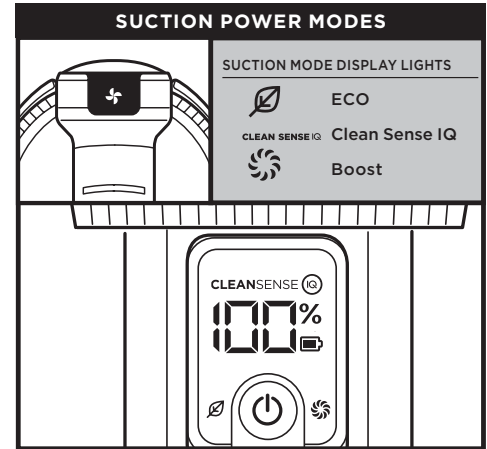
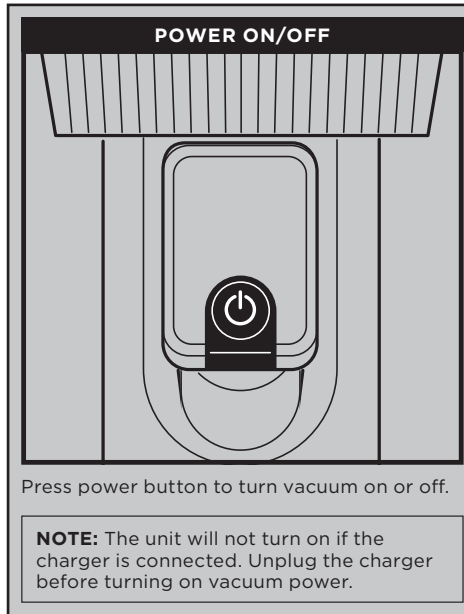

Press the (mode selection) button to toggle between ECO, Clean Sense IQ, and Boost modes. To save battery power, select ECO mode. For everyday cleaning power, select Clean Sense IQ mode. For an extra burst of power, select Boost mode.

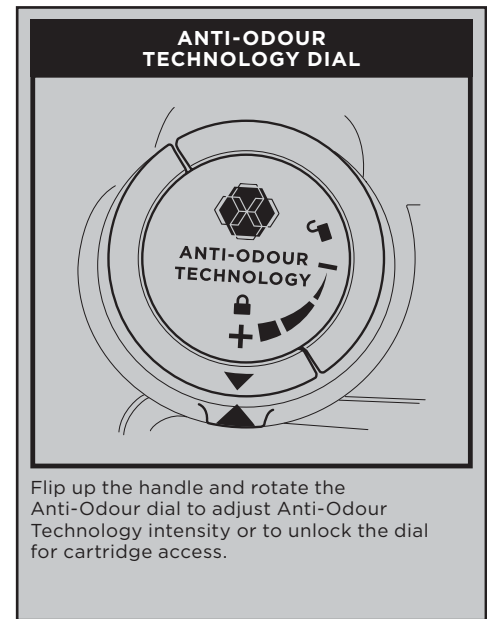
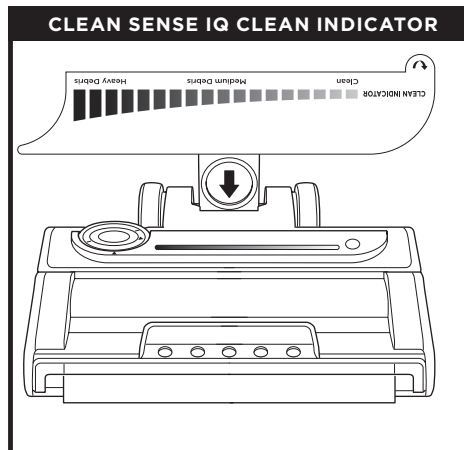

ESSENTIAL MAINTENANCE

CLEANING THE FILTERS

Regularly rinse and reinstall the filters to maintain your vacuum's suction power and to maximise the effectiveness of the odour cartridge.

To clean filters, rinse them with water only. Allow all filters to air-dry completely for up to 48 hours before reinstalling, to prevent liquid from being drawn into electric parts.

Clean the pre-motor filters at least once a month and post-motor filter at least once a year. Tap off loose dirt between washes when needed. More frequent cleaning may sometimes be necessary with heavy use.

IMPORTANT: DO NOT use soap when cleaning the filters. Use water only. The vacuum will not have suction if the post-motor filter is not installed. Ensure that all filters are installed before using.

CLEANING THE CLEAN SENSE IQ SENSORS

If the Clean Sense IQ sensors are dirty, the nozzle light bar will flash and the vacuum will operate in a standard power setting until sensors are cleaned. Clean using a microfibre cloth.

