

Shark **POWERDETECT**

Robotic Vacuum Cleaner

RV2800ZEUK / AV2800ZEUKWH SERIES

INSTRUCTIONS



SHARKCLEAN APP



Illustrations may differ from actual product. We are constantly striving to improve our products, therefore the specifications contained herein are subject to change without notice.

 sharkclean.co.uk



IMPORTANT SAFETY INSTRUCTIONS

PLEASE READ CAREFULLY BEFORE USE • FOR HOUSEHOLD USE ONLY

⚠ WARNING

To reduce the risk of fire, electric shock, injury, or property damage:

CHILDREN OR ANIMALS SHOULD NOT BE LEFT UNATTENDED IN ANY ROOMS THAT THE ROBOTIC VACUUM HAS ACCESS TO DURING CLEANING.

LASER WARNING

THIS PRODUCT HAS A CLASS 1 LASER. ALWAYS TURN OFF THE POWER BEFORE LIFTING THE ROBOTIC VACUUM CLEANER OR PERFORMING ANY MAINTENANCE ON IT. DO NOT LOOK DIRECTLY INTO LASER.

IF THE CHARGING CABLE PLUG DOES NOT FIT FULLY INTO THE SOCKET, CONTACT A QUALIFIED ELECTRICIAN. DO NOT FORCE INTO SOCKET OR TRY TO MODIFY TO FIT.

GENERAL WARNINGS

When using an electrical appliance, basic precautions should always be followed, including the following:

1. This appliance consists of a Robot Floor Cleaner vacuum and charging dock with power supply. These components contain electrical connections, electrical wiring, and moving parts that potentially present risk to the user.
2. Before each use, carefully inspect all parts for any damage. If a part is damaged, discontinue use.
3. Use only identical replacement parts.
4. This Robot Floor Cleaner contains no serviceable parts.
5. Use only as described in this manual. DO NOT use Robot Floor Cleaner for any purpose other than those described in this manual.
6. With the exception of some filters and dust bin, DO NOT expose any parts of the robotic vacuum cleaner to water or other liquids.
7. **DO NOT put hands into any opening in the dock or robot.**

8. USE WARNINGS

- This product has a Class 1 Laser. Always turn off the power before lifting the robotic vacuum cleaner or performing any maintenance on it.
9. **DO NOT** look directly into laser.
 10. Always turn off the robotic vacuum cleaner before inserting or removing the filter or dustbin.
 11. **DO NOT** handle plug, charging dock, charging cable or Robot Floor Cleaner with wet hands. Cleaning and user maintenance must not be done by children without supervision
 12. Children should **NOT** play with the appliance.
 13. This appliance can be used by children aged from 8 years and above and persons with reduced physical, sensory, or mental capabilities or lack of experience and knowledge if they have been given supervision or instruction concerning use of the appliance in a safe way and understand the hazards involved.
 14. **DO NOT** use the robot without the dustbin, filter in place.

15. **DO NOT** damage the charging cord:
 - a) **DO NOT** pull or carry charging dock by the cord or use the cord as a handle.
 - b) **DO NOT** unplug by pulling on cord. Grasp the plug, not the cord.
 - c) **DO NOT** close a door on the cord, pull the cord around sharp corners, or leave the cord near heated surfaces.
 - d) The supply cord cannot be replaced. If the cord is damaged the appliance should be scrapped.
16. **DO NOT** put any objects into nozzle or accessory openings. **DO NOT** use with any opening blocked; keep free of dust, lint, hair, and anything that may reduce airflow.
17. **DO NOT** use if Robot Floor Cleaner airflow is restricted. If the air paths become blocked, turn the vacuum cleaner off and remove all obstructions before turning on the unit again.
18. Keep nozzle and all vacuum openings away from hair, face, fingers, uncovered feet, or loose clothing.
19. **DO NOT** use if Robot Floor Cleaner is not working as it should, or has been dropped, damaged, left outdoors, or dropped into water.
20. **DO NOT** place vacuum cleaner on unstable surfaces.
21. **DO NOT** use to pick up:
 - a) Liquids.
 - b) Large objects.
 - c) Hard or sharp objects (glass, nails, screws, or coins).
 - d) Large quantities of dust (drywall dust, fireplace ash, or embers.)
 - e) DO NOT use as an attachment to power tools for dust collection.
 - f) Smoking or burning objects (hot coals, cigarette butts, or matches).
 - g) Flammable or combustible materials (lighter fluid, petrol, or kerosene).
 - h) Toxic materials (chlorine bleach, ammonia, or drain cleaner).
 - i) Toxic materials (high concentrations of chlorine bleach liquid, high concentrations of ammonia, or drain cleaning solution).

22. **DO NOT** use in the following areas:
 - a) Wet or damp surfaces
 - b) Outdoor areas near fireplaces with unobstructed entrances
 - c) Spaces that are enclosed and may contain explosive or toxic fumes or vapors (lighter fluid, petrol, kerosene, paint, paint thinners, mothproofing substances, or flammable dust
 - d) In an area with a space heater
 - e) Near fireplaces with unobstructed entrances.
23. Turn off the Robot Floor Cleaner before any adjustment, cleaning, maintenance or troubleshooting. Note: in the OFF (O) position, the robot still uses a small amount of power.
24. Allow all filters to air-dry completely before reinstalling them to prevent liquid from being drawn into electric parts.
25. **DO NOT** modify or attempt to repair the robotic vacuum cleaner or the battery yourself, except as indicated in this Owner's Guide. **DO NOT** use the vacuum if it has been modified or damaged.
26.  Keep fingers clear of wheels and suspension system while robot is powered on at all times.
27. **DO NOT** use any household cleaners (all-purpose cleaners, glass cleaners, bleach) on any of the polished high gloss surfaces on the docking station or robot vacuum cleaner as they contain chemicals that may damage these surfaces. Instead use a cloth dampened with water to gently clean.
28. To minimise the risk of the robot traveling beyond an unsafe boundary (stair or cliff edges, fireplaces, water hazards), establish these areas as no-go zones using the mapping feature in the SharkClean mobile app. Upon setting the boundary, run the vacuum and visually confirm that the settings effectively prevent the robot from passing beyond the set boundary. Adjust settings as necessary. For nonapp users, use a boundary to block off an unsafe boundary.

BATTERY USE

29. The battery is the power source for the vacuum. Carefully read and follow all charging instructions.
30. To prevent unintentional starting, ensure the vacuum is powered off before picking it up or carrying it.
30. Use only the SHARK charging dock and battery outlined in the table below. and use only battery RVBAT85002 (33V) RVBAT850 (MH1), or RVBAT850 (26V). Use of batteries or battery chargers other than those indicated may create a risk of fire.
32. Keep the battery away from all metal objects such as paper clips, coins, keys, nails, or screws. Shorting the battery terminals together increases the risk of fire or burns.
33. Under abusive conditions, liquids may be ejected from the battery. Avoid contact with this liquid, as it may cause irritation or burns. If contact occurs, flush with water. If liquid contacts eyes, seek medical help.
34. Robotic vacuum cleaner should not be stored, charged, or used at temperatures below 10°C (50°F) or above 40°C (104°F). Ensure the battery and vacuum have reached room temperature before charging or use. Exposing the robot or battery to temperatures outside of this range may damage the battery and increase the risk of fire.
35. **DO NOT** expose the Robot Floor Cleaner or battery to fire or temperatures above 130°C (265°F) as it may cause explosion.

Unit	Battery
SKU	RVBAT85002 (33V) RVBAT850 (MH1), or RVBAT850 (26V).

Unit	Dock
SKU	XDRV2800WDEUK XDOCK2800WDEUK

SAVE THESE INSTRUCTIONS

For the latest warnings and cautions, go to www.sharkclean.co.uk/robothelp

Please be sure to read the online Shark® Owner's Guide prior to using your robot.

Shark POWERDETECT QUICK START GUIDE

DOWNLOAD THE SHARKCLEAN APP



Scan QR code with your phone's camera to quickly find and download the app

END-USER LICENSE AGREEMENT FOR SHARKNINJA SOFTWARE

SharkClean.co.uk/EULA

sharkclean.co.uk

GETTING THE MOST OUT OF YOUR ROBOT

To get the best experience, download the SharkClean app and follow the tips below.

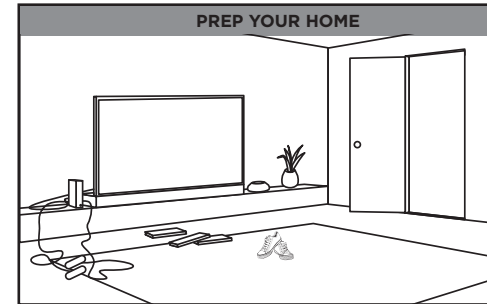

Your Power Detect robot will avoid cords, but for the best coverage and cleaning, remove cords and objects smaller than 11.5 cm in height from floors. To ensure a complete map of your home, open interior doors.

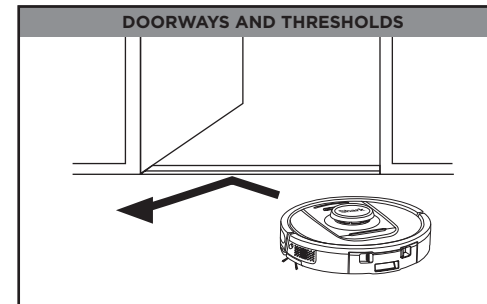

Your robot can easily climb over most thresholds, but if one is higher than 2.5cm, set up a no-go zone in the app to block it off.

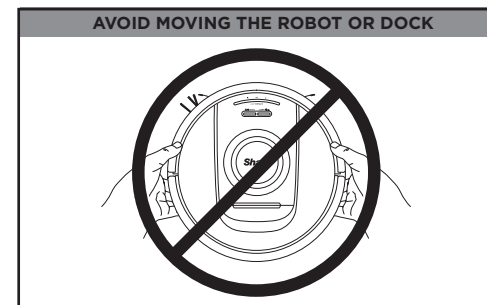

While your robot is cleaning, do not pick it up and move it, or move the Self-Empty Base—this will impact the robot's ability to map your home.

SCHEDULING AND INTERACTIVE MAP



- For a constant state of clean, set up a whole-home cleaning schedule in the app.
- Use the interactive home map for an even more customisable clean.

NO-GO ZONES

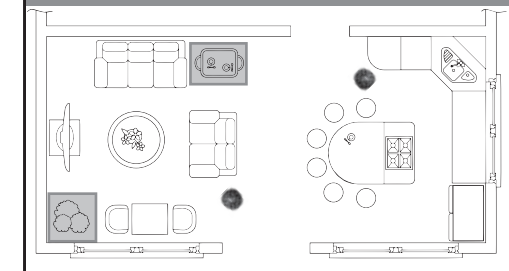

Create no-go zones in the app to keep your robot out of the areas you would like it to avoid:

- Near power cords or phone chargers.
- In front of high thresholds.

SETUP

STEP 1 PREP THE ROBOT

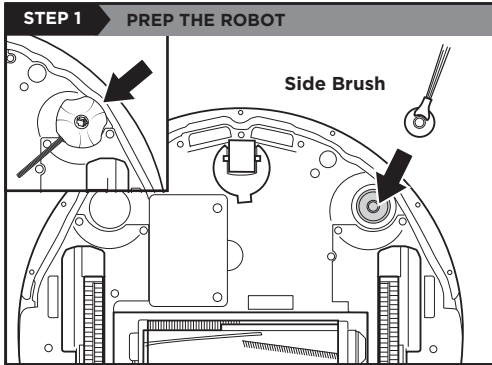

- Remove protective film from robot and dock.
- Attach side brush.
- Side brush design may vary. Some models include a spare.

STEP 3 INSTALLING THE ODOUR NEUTRALIZER*

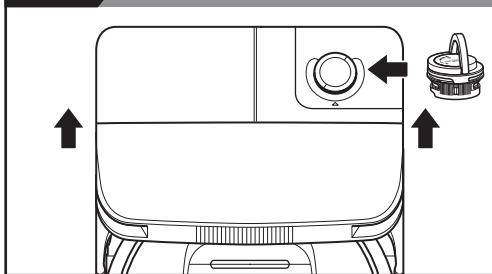

Insert Odour Cartridge Assembly

1. Insert cartridge assembly into the top of the base.
2. Rotate the cartridge until it clicks into place.

Note: Make sure the odour cartridge assembly is installed in the base before using the robot.

*Not included with all models.

STEP 5 FILL THE CLEAN WATER TANK

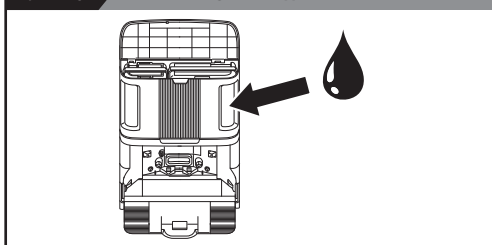

- Lift the lid on the top front half of the base. Remove the clean water tank on the right side.
- Fill the tank with room-temperature water up to the MAX fill line, then reinstall the tank.
- **Ensure the base is not placed in area with direct sunlight.**

STEP 2 SET UP THE SELF-EMPTY BASE

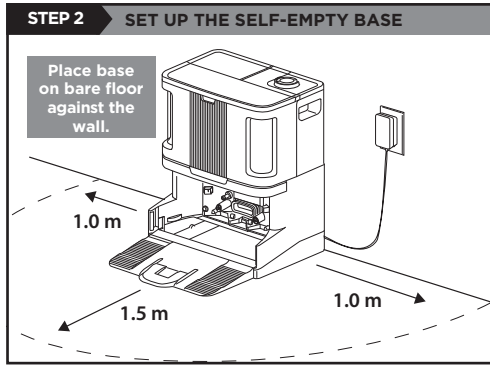

- Find a **permanent** location for the base in a central area with a **strong Wi-Fi signal**.
- Remove any objects that are closer than 1m. from either side of the base, or closer than 1.5m. from the front.
- Plug in the base.

*Ensure the base is not placed in area with direct sunlight.

STEP 4 INSTALL RAMP ON BASE

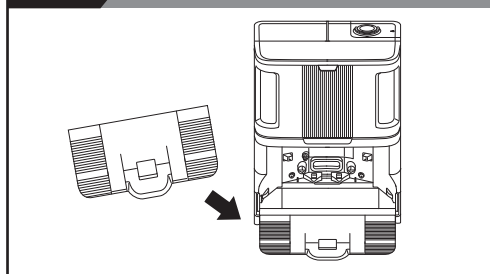

- Align the flat end of the ramp with the base and insert the ramp into the base.
- Lift the ramp slightly above the base, align, and press down until the ramp clicks into place.

STEP 6 CHARGING YOUR ROBOT

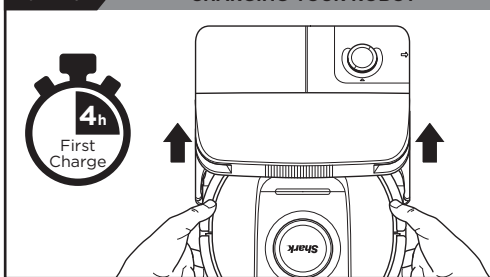

- Align the robot with the Shark logo upside down, then slide it up the ramp, onto the base.
- Place robot on base to charge for **4 hours**.
- Make sure the robot is properly aligned on the **base**.
- **TO TURN ON ROBOT:** Place robot on base or press and hold the **DOCK** button for 5 to 7 seconds until the indicator lights turn on.

*charge times may vary

SETUP

STEP 6 DOWNLOAD THE APP

SharkClean App Features

- ✓ Precision Home Mapping
- ✓ Room Select
- ✓ Spot Cleaning
- ✓ No Go Zones
- ✓ Scheduling
- ✓ Deep Cleaning
- ✓ Maintenance Reminders



CAN'T CONNECT TO WI-FI?



Restart your phone

- Turn off phone, wait a few minutes, then turn it back on and connect to Wi-Fi.

Reboot your robot

- Take robot off dock and press and hold down the DOCK button on the robot for 12 seconds. Turn your robot back on by sliding it up the ramp onto the dock.

Reboot your router

- Unplug the router power cable for 30 seconds, then plug it back in. Allow several minutes for your router to reboot completely.

Search "SharkClean" in the app store or scan the QR code on the front cover to download the app.

Questions? Steps if You're Stuck:

Having trouble connecting to your robot? For how-to videos, FAQs, troubleshooting, and tips & tricks visit: sharkclean.co.uk.



For full instruction booklet visit: qr.sharkclean.com/RVDetectProUKseries
SCAN HERE USING YOUR SMARTPHONE CAMERA

- To use the app, your phone must be connected to a 2.4 GHz network. The app will not work on a 5 GHz network.
- **DO NOT** use a VPN or a proxy server.
- Make sure Wi-Fi isolation is turned off on the router.

BEFORE YOU CLEAN

Your robot will need to complete an Explore Run to create a map of your home.

The robot requires $\geq 70\%$ battery to start an explore mission.

In the Explore Run, your robot will wander around your home as it creates a map. The first Explore Run will include a vacuum cycle as it maps, and will identify carpeted areas whilst on this Explore Run.

After this run, you can create No-Go Zones in the areas of your home that you want to the robot to avoid while cleaning. If you do not want to set up No-Go Zones, you can skip this step.

Now you're ready to clean.

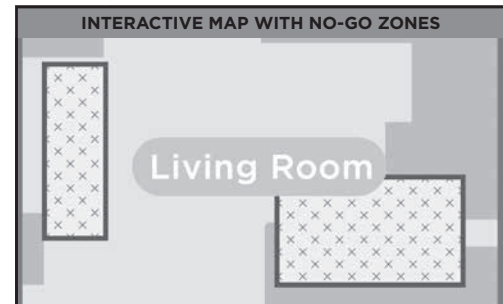

CLEANING ROBOT'S PRE MOTOR FILTER

IMPORTANT - Clean filter every month or loss of suction may occur.

Rinse and let air dry completely. Allow filter to dry for 48 hours before reinstalling. Also, tap loose dirt off filter between washes as needed.

Foam filters may appear dirty after use-this is normal.



DO NOT put your hands into any opening not defined for user access

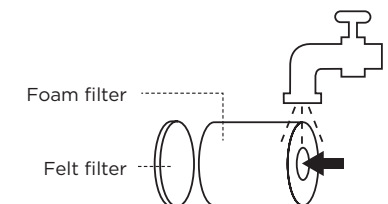

MANUFACTURER'S GUARANTEE

The Shark Guarantee

When a consumer buys a product in the UK, they get the benefit of legal rights relating to the quality of the product (your "legal rights"). You can enforce your legal rights against your retailer, including Shark if you bought your appliance from sharkclean.co.uk. However, at Shark we are so confident about the quality of our products that we give the owner an additional, free parts and labour manufacturer's guarantee of up to 2 years.

The guarantee it comes with is an important consideration - and reflects how much confidence the manufacturer has in its product and manufacturing quality.

The manufacturer's guarantee does not affect your legal rights.

How long are new Shark machines guaranteed for?

Our manufacturer's guarantee lasts for one year from the date of purchase as standard, or for two years if you register your purchase with us within 28 days.

How do I register my Shark guarantee?

If you have purchased your Shark appliance directly from sharkclean.co.uk your guarantee is registered automatically. If you bought it from anywhere else in the UK, you can register your guarantee online within 28 days of purchase.

- To register online, please visit sharkclean.co.uk/register-guarantee or scan the QR code in your instruction booklet.
- Keep a note of the date you purchased the machine.

IMPORTANT:

- Keep your receipt if you bought your Shark appliance from anywhere except sharkclean.co.uk. You will need it to claim under your guarantee.
- The free Shark guarantee only applies in the UK.

What are the benefits of registering my free Shark guarantee?

When you register your guarantee, you will get an extra one year of cover. We'll also have your details to hand if we ever need to get in touch. If you further agree to receive communications from us, you can also receive tips and advice on how to get the best out of your Shark appliance and hear the latest news about new Shark technology and launches.

What is covered by the free Shark guarantee?

Repair or replacement (at Shark's discretion) of your Shark machine, including all parts and labour.

What is not covered by the free Shark guarantee?

- Normal wear and tear.
- Accidental damage or faults caused by negligent use or care, misuse, neglect, careless operation or handling of the Shark appliance which is not in accordance with the Shark Operating Manual supplied with your machine.
- Damage caused by use of the Shark appliance for anything other than normal domestic household purposes.
- Damage caused by use of parts not assembled or installed in accordance with the operating instructions.
- Damage caused by use of parts and accessories which are not Shark Genuine Components
- Faulty installation (except where installed by Shark).
- Repairs or alterations carried out by parties other than Shark or its agents.

MANUFACTURER'S GUARANTEE

How can I claim under the free Shark guarantee?

Contact our customer service helpline on 0800 862 0453. For service hours please visit our website under 'Contact Us'. It's free to call, and you'll be put straight through to a Shark representative. You'll also find online support at support.sharkclean.co.uk. The Shark representative will go through some troubleshooting with you, and if we conclude that the item has failed, we will send you a replacement part or a returns label to send the defective item back to us free of charge. When you have delivered the defective product to us, we will send you a replacement.

Please remember that the item will need to be boxed when you return it to us. It can be any suitable box, it does not have to be the original packaging.

Where can I buy genuine Shark spares and accessories?

Shark spares and accessories are developed by the same engineers who developed your Shark appliance. You'll find a full range of Shark spares, replacement parts and accessories for all Shark machines at sharkclean.co.uk. Please remember that damage caused by the use of non-Shark spares may not be covered under your guarantee.

These instructions are designed to help you keep your Shark Robot running at peak performance.

SharkNinja Europe Ltd,

1st/2nd Floor Building 3150,
Thorpe Park,
Century Way,
Leeds, England,
LS15 8ZB

SharkNinja Germany GmbH,

Rotfeder-Ring 9,
60327 Frankfurt am Main, Germany
sharkclean.co.uk

Illustrations may differ from actual product. We are constantly striving to improve our products; therefore the specifications contained herein are subject to change without notice.



**SharkNinja Europe Ltd,
1st/2nd Floor Building 3150,
Thorpe Park,
Century Way, Leeds, England,
LS15 8ZB
www.sharkclean.co.uk**

**SharkNinja Germany GmbH,
Rotfeder-Ring 9,
60327 Frankfurt am Main,
Germany
www.sharkclean.co.uk**

Illustrations may differ from actual product We are constantly striving to improve our products; therefore the specifications contained here in are subject to change without notice.

© 2024 SharkNinja Operating LLC. SHARK is a registered trademark in the United Kingdom of SharkNinja Operating LLC.

Apple App Store is a trademark of Apple Inc.

Google, Android and Google Play are trademarks of Google LLC.



© 2024 SharkNinja Operating LLC. Printed in China.

RV2800ZEUK_QSG_E_F_MP_Mv3_240604